

SuiteMijas

PORTAL 06_PLANTA BAJA_VIV.E

RESUMEN SUPERFICIES ÚTILES

| | |
|--------------------------------|----------------------|
| Total superficie útil interior | 60.92 m ² |
| Total superficie útil exterior | 30.86 m ² |
| Total superficie útil vivienda | 91.78 m ² |

RESUMEN SUPERFICIES CONSTRUIDAS

| | |
|---|-----------------------|
| Total superficie construida interior | 69.74 m ² |
| Total superficie construida exterior | 34.60 m ² |
| Total superficie construida con comunes | 115.69 m ² |

RESUMEN SUPERFICIES SEGUN DECRETO 218/2005

| | |
|----------------------------|----------------------|
| Superficie útil BOJA | 67.01 m ² |
| Superficie construida BOJA | 90.93 m ² |

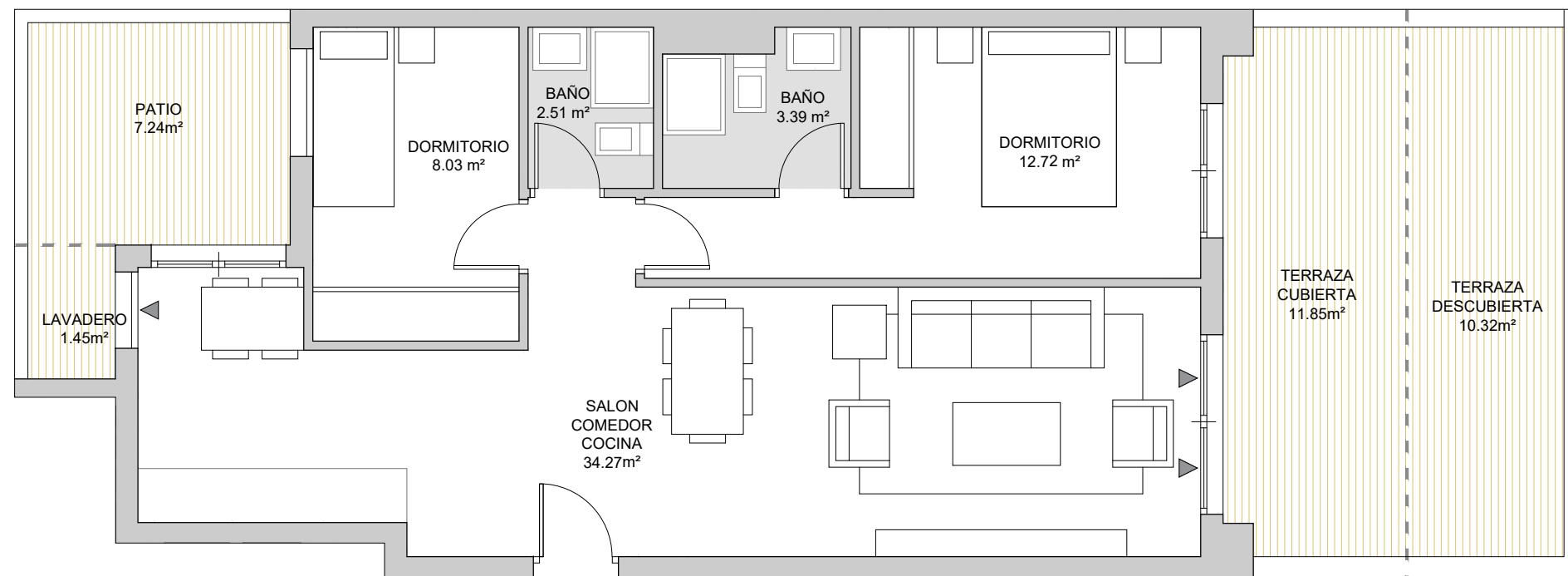

Planta Baja

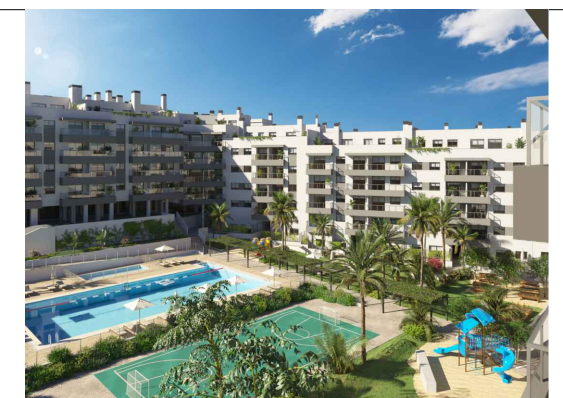
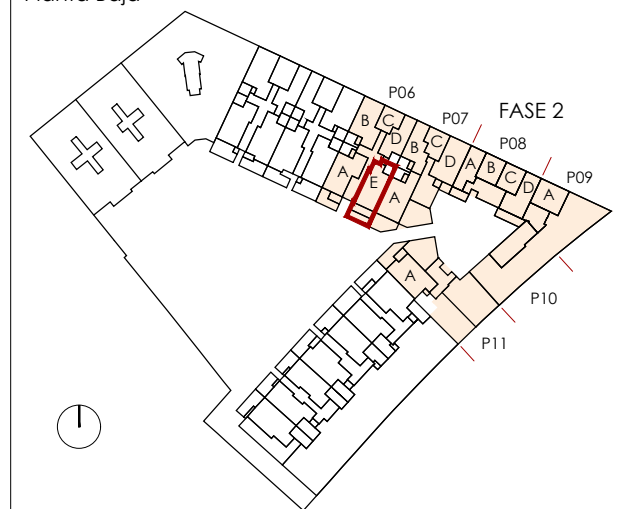

brosh

0m 0,5 1 1,5